

OREGON CORNER RESTORATION FORM

Section 8 Township 1S Range 23E
 County Morrow Date: April 17, 2019

Corner Designation: 1S23E7

Quarter corner common to sections 5 and 8, T1S, R23E, W.M., Morrow County, Oregon.

Condition Report Only
 Not found
 Remonumented
 Unrecorded
 Surveyed in
 Referenced out

Previous Renewals / Surveys, etc.

Corner originally set by David P. Thompson under contract No. 109 dated January 30, 1865. His record reads: Set a post for 1/4 Sec. Cor. in mound of earth with charred stake, pits, & c. as per instructions. The county road notes for county road No. 512 (Zinter Road) states that this road begins at the north 1/4 stake in Section 8. The road notes for county road 49 also call for an angle point at the quarter post to sections 5 and 8.

Monument and Accessories found: (condition and source)

The intersection of county roads with roads running North, South, East, and West.

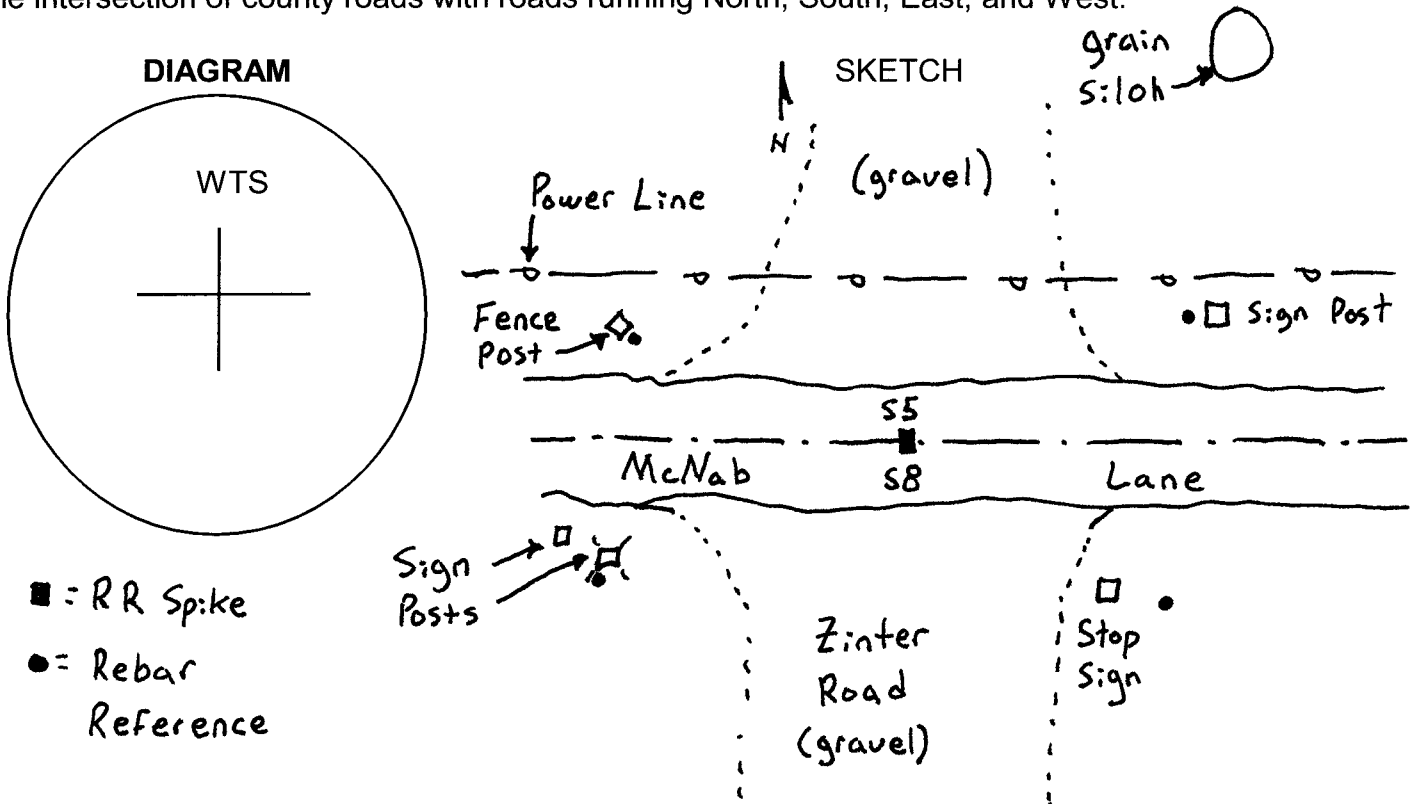

MONUMENT (S) AND ACCESSORIES SET (Procedures and Description)

At the intersection of road centerlines a drove a railroad spike in the asphalt marked WTS and having an "X" cut in the top.

For references I set four, 5/8" by 24" rebars with 1 1/8" orange plastic caps attached, stamped WTS and 56295LS as described below:

- an iron rebar bears N26°49'17"W, 30.48 feet at the foot of a wooden fence post;
- an iron rebar bears N51°24'42"E, 42.93 feet at the foot of a wooden sign post;
- an iron rebar bears S30°37'46"W, 49.16 feet at the broken off remains of a wooden sign post;
- an iron rebar bears S22°15'25"E, 54.28 feet 20 inches below the surface of a farm field;

The monument and references were tied using a Trimble R7/R8 RTK GPS.

Location and comments

Witnessed By:

RECEIVED BY:

Morrow County Surveyor

Date: 5-27-2019

Rec'd By: S.K.H.

No. 1523 E 7

Survey No. _____

Compass Declination

Firm / Agency

Witness Tree Surveying

Address

P.O. Box G

Pilot Rock, Or. 97868

Party Chief

Stephen K. Haddock

Surveyors Seal

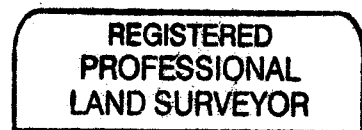

Stephen K. Haddock

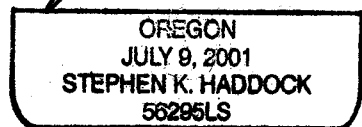

RENEWS: 6-30-21