

OREGON CORNER RESTORATION FORM

Section 10 Township 1S Range 23E
 County Morrow Date: April 17, 2019

Corner Designation: 1S23E13

Corner common to sections 3, 4, 9, and 10, T1S, R23E,
 W.M., Morrow County, Oregon.

Condition Report Only
 Not found
 Remonumented
 Unrecorded
 Surveyed in
 Referenced out

Previous Renewals / Surveys, etc.

The corner was originally set by David P. Thompson under contract 109 dated January 30, 1865.
 record reads: Set a post for corner to Secs. 3, 4, 9, & 10 in mound of earth with charred stake, pits
 & c. as per instructions.

Monument and Accessories found: (condition and source)
 None. The point falls in the center of McNab Lane.

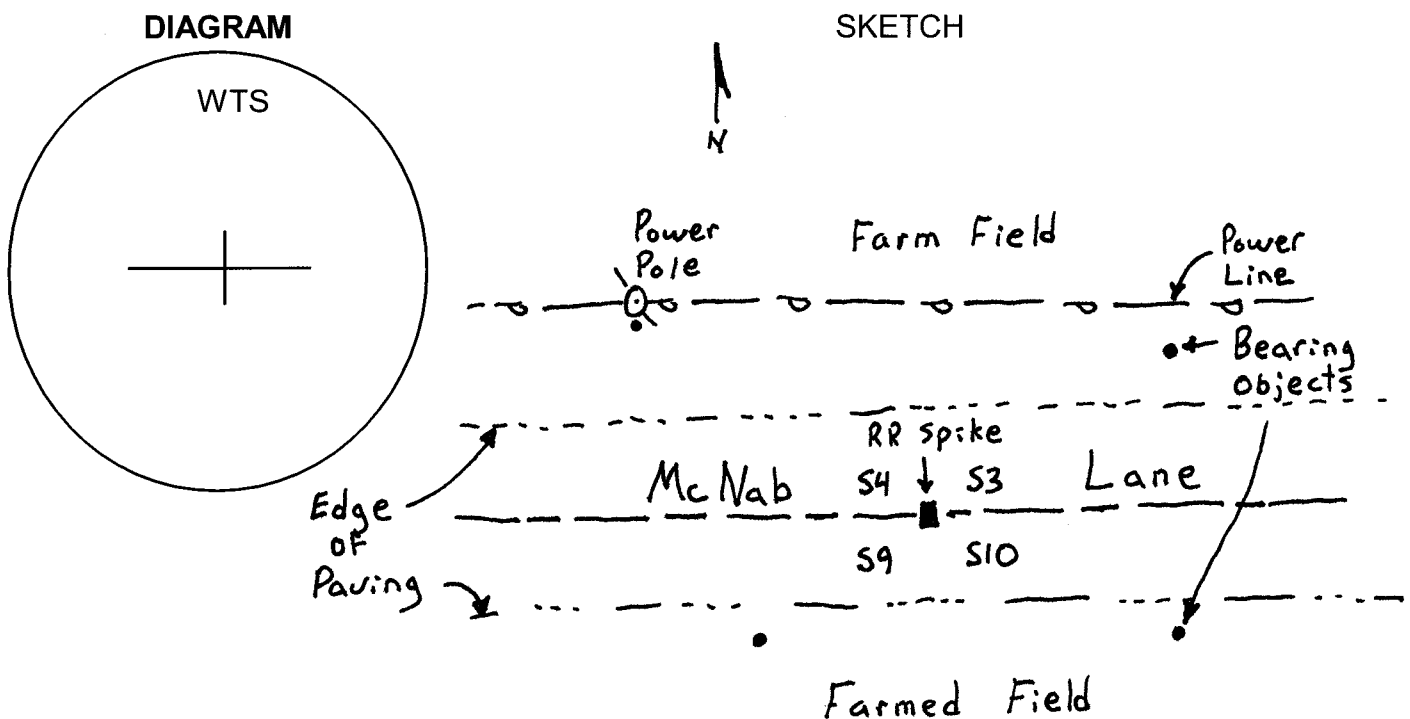

MONUMENT (S) AND ACCESSORIES SET (Procedures and Description)

I set a railroad spike in the asphalt marked WTS and having an "X" cut in the top at the position determined by proportioning the departure and holding the east-west centerline of McNab Lane for latitude.

For references, I set four, 5/8" by 24" rebars with 1.25" orange plastic caps stamped WTS and 56295LS as described below:

- an iron rebar bears N67°42'09"W, 64.45 feet on the south side of a power pole;
- an iron rebar bears N59°28'00"E, 38.95 feet, 18 inches below the surface;
- an iron rebar bears S53°01'00"W, 39.51 feet, 18 inches below the surface;
- an iron rebar bears S53°03'23"E, 42.81 feet, 18" below the surface;

Measurements were made with a Trimble RTK GPS.

Location and comments

Witnessed by:

RECEIVED BY:

Morrow County Surveyor

Date: 5-27-2019

Rec'd By: S.K.H.

No. 1S23E13

Survey No. _____

Compass Declination

Firm / Agency

Witness Tree Surveying

Address

P.O. Box G

Pilot Rock, Or. 97868

Party Chief

Stephen K. Haddock

Surveyors Seal

REGISTERED
 PROFESSIONAL
 LAND SURVEYOR

Stephen K. Haddock

OREGON
 JULY 9, 2001
 STEPHEN K. HADDOCK
 56295LS

RENEWS: 6-30-21