

OREGON CORNER RESTORATION FORM

T1N R30E Z1

Section 31, Township 1N, Range 30E,
County Umatilla, Date December 10, 2004.

—	Condition Report
—	Not Found
—	Remonumented
—	Unrecorded
<u>X</u>	Surveyed in
<u>X</u>	Referenced out

Township corner common to Township 1 North Ranges 29 and 30 East on the Willamette Base Line, Umatilla County.

Previous Renewals / Surveys, etc.

The corner was originally set by David P. Thompson under Contract No. 79 dated July 26, 1858. His record Reads: Set post for corner to Townships 1 North of Ranges 29 and 30 East and build a mound of earth and c. as per instructions.

Monument and accessories found: (Condition and source)

None. The point falls in a fenced stock drive lane which runs North and East.

DIAGRAM

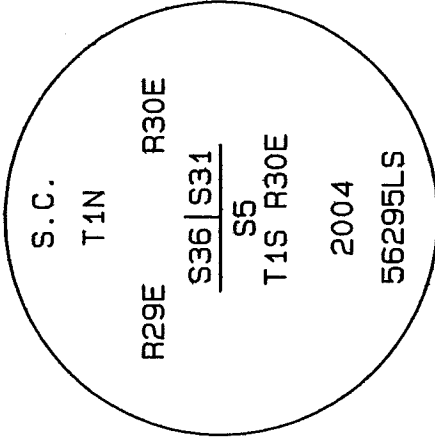

SKETCH

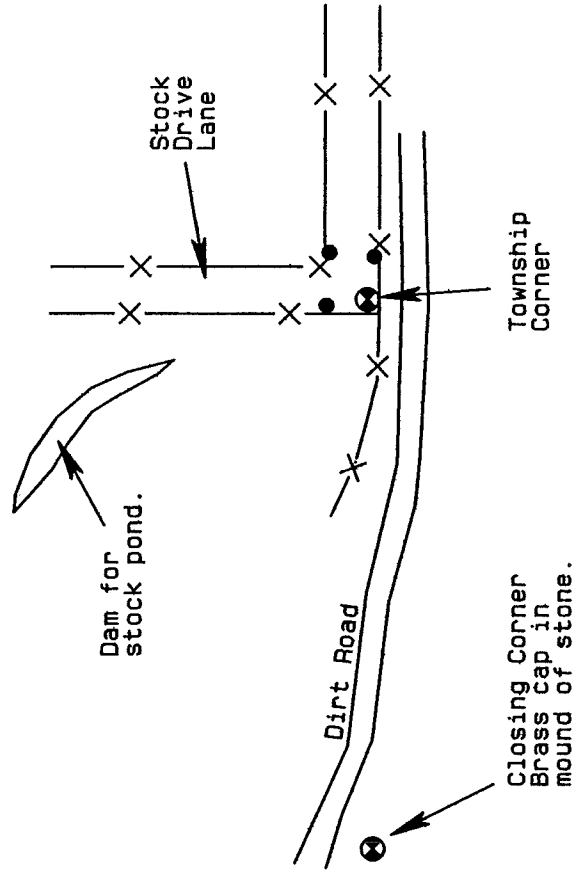

- ⊗ = Brass Cap
- = Iron Rebar Reference

Monument and accessories set: (Procedures and description)

I set a 2 3/8" brass cap on a 30" x 1 3/8" O.D. galvanized iron pipe 32" in the ground. The cap was stamped as shown in the diagram above. I attached a County Monument sign to a nearby fence post.

For references I set three 5/8" x 24" iron rebars with 1.25" orange plastic caps stamped WTS and 56295LS:

- an iron rebar bears N50°58'49"E 47.51 feet near the north stock drive fence;
- an iron rebar bears S80°51'41"E 34.20 feet near the south stock drive fence;
- an iron rebar bears N8°25'35"W 32.50 feet near the west stock drive fence;
- the brass cap set at the closing corner to T1S, R30E, S5/S6, by Gaylord bears S89°20'19"W 430.89 feet in an old rock jack.

Survey control was established using a Trimble R7/R8 GPS and static surveying procedures. The monument and references were set using a Trimble 5601 Robotic total station and radial methods. Bearings and distances are Grid.

Location and Comments
 SPC Oregon North, NAD 83-91
 Northing = 677,174.90 ift
 Easting = 8,555,025.26 ift

Surveyor's Seal

Witnessed By:

RECEIVED BY:
Umatilla County Surveyor

Date: 5-05

Rec'd By: KK

No. 05-11-c

Firm / Agency
 Witness Tree Surveying
 P.O. Box G
 Pilot Rock, OR 97868
 Party Chief
 Stephen K. Haddock, PLS

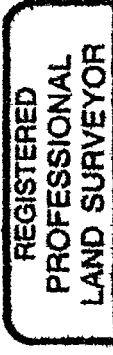

Stephen K. Haddock

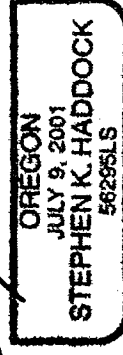

RENEWAL DATE 6-30-05