

# OREGON CORNER RESTORATION FORM

T1N R29E A1

Section 6, Township 1N, Range 29E,  
County Umatilla, Date April 6, 2005.

—	Condition Report
—	Not Found
<u>X</u>	Remonumented
—	Unrecorded
—	Surveyed in
<u>X</u>	Referenced out

Township corner common to Townships 1 and 2 North,  
Ranges 28 and 29 East, W.M., Umatilla County, Oregon.

Previous Renewals / Surveys, etc.

The corner was originally set by David P. Thompson under Contract No. 83 dated July 22, 1859. His record Reads: Set post for corner to Townships 1 and 2 North or Ranges 28 and 29 East in mound of earth &c as per instructions.

Monument and accessories found: (Condition and source)

I found the remains of a decayed post at the intersection of the remains of fences. The fences ran North, South and Southeasterly. The decayed wood may have been the old fence corner post. This location agrees well with measurements to other corners and possessory lines in the area and is the best available evidence.

### DIAGRAM

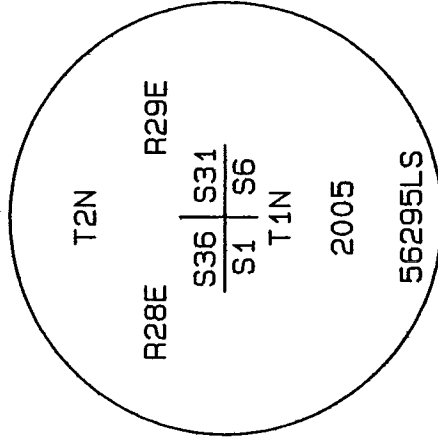

### SKETCH

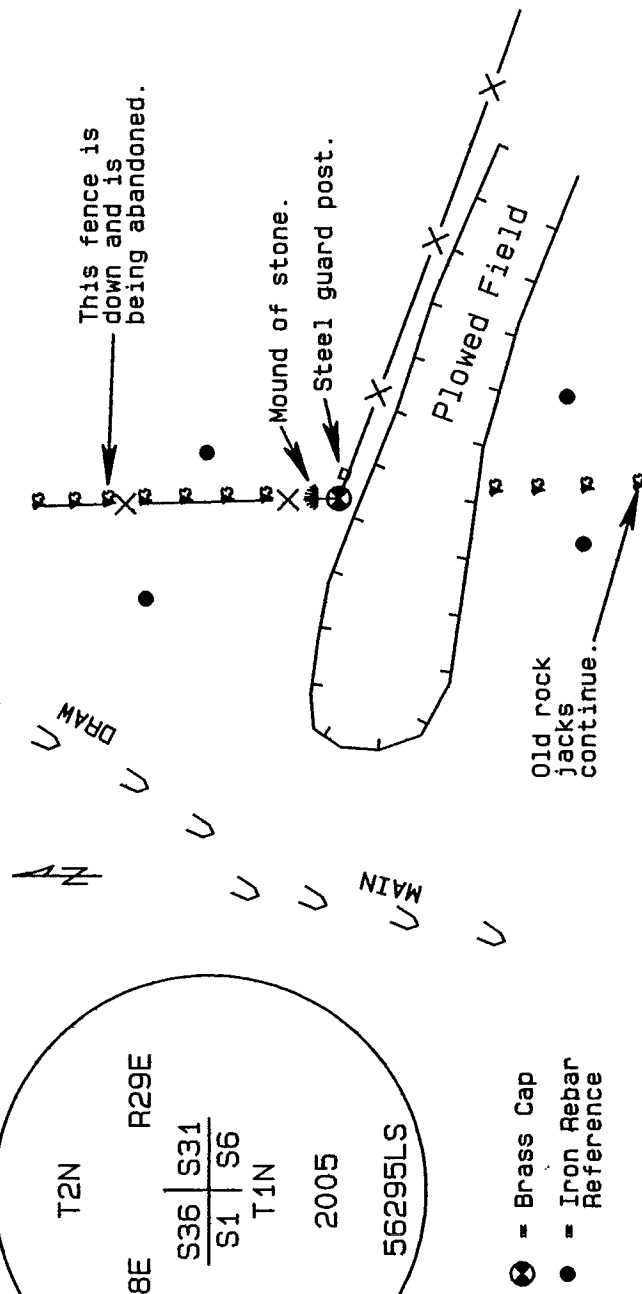

- ⊗ = Brass Cap
- = Iron Rebar Reference

Monument and accessories set: (Procedures and description)

At the position of the decayed post I set a 2 3/8" brass cap on a 1 1/2" x 30" galvanized iron pipe 30" in the ground with an 18" collar of stone. I built a mound of stone with a 3' base and 3' high, 4 feet north of the cap. I set a 6' steel guard post along side with a county monument sign attached.

For references I set four 5/8" x 24" iron rebars with 1.25" orange plastic caps attached stamped WTS and 56295LS:  
an iron rebar bears N19°10'55"E 109.28 feet, flush with the surface;  
an iron rebar bears N27°34'02"W 170.64 feet, 6" below the surface;  
an iron rebar bears S10°33'16"W 193.93 feet, 6" below the surface;  
an iron rebar bears S24°16'57"E 194.99 feet, 6" below the surface;  
The monument and references were tied with a Trimble R7/R8 GPS system using static surveying procedures. Bearings and distances are grid.

Location and Comments  
SPC Oregon North, NAD 83-91  
Northing = 708,055.23 ift  
Easting = 8,522,447.34 ift

Compass Declination

Surveyor's Seal

Witnessed By:

RECEIVED BY:  
Umatilla County Surveyor

Date: 5-05

Rec'd By: KK

No. 05-111-C

Firm / Agency

Witness Tree Surveying  
P.O. Box 6  
Pilot Rock, OR 97868  
Party Chief  
Stephen K. Haddock, PLS

REGISTERED  
PROFESSIONAL  
LAND SURVEYOR

*Stephen K. Haddock*

OREGON  
JULY 9, 2001  
STEPHEN K. HADDOCK  
56295LS

RENEWAL DATE 6-30-05