

OREGON CORNER RESTORATION FORM

T1N R29E X1

Section 31, Township 1N, Range 29E,
County Umatilla, Date April 5, 2004.

—	Condition Report
—	Not Found
<u>X</u>	Re monumented
—	Unrecorded
—	Surveyed in
<u>X</u>	Referenced out

The quarter corner common to Section 36, T1N, R28E and Section 31, T1N, R29E, W.M., Umatilla County, Oregon.

Previous Renewals / Surveys, etc.

The corner was originally set by L. F. Cartee under Contract No. 88 dated May 11, 1860. His record Reads: Set post for qr. sec. cor. and built mound of stone as per instructions.

Monument and accessories found: (Condition and source)

I found a basalt stone 14" x 7" x 5" plainly marked 1/4 CS lying loose in the top of a small mound of stones immediately south of a decayed rock jack in an old north - south fence line. The stone was over the top of a decayed wooden post.

DIAGRAM

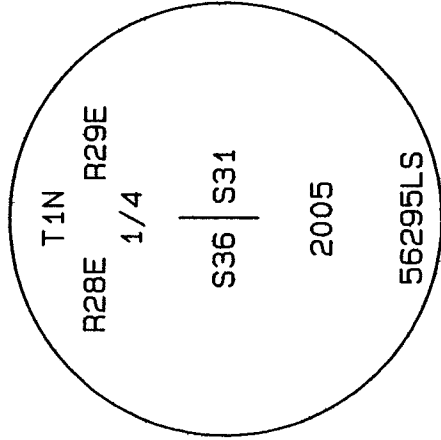

SKETCH

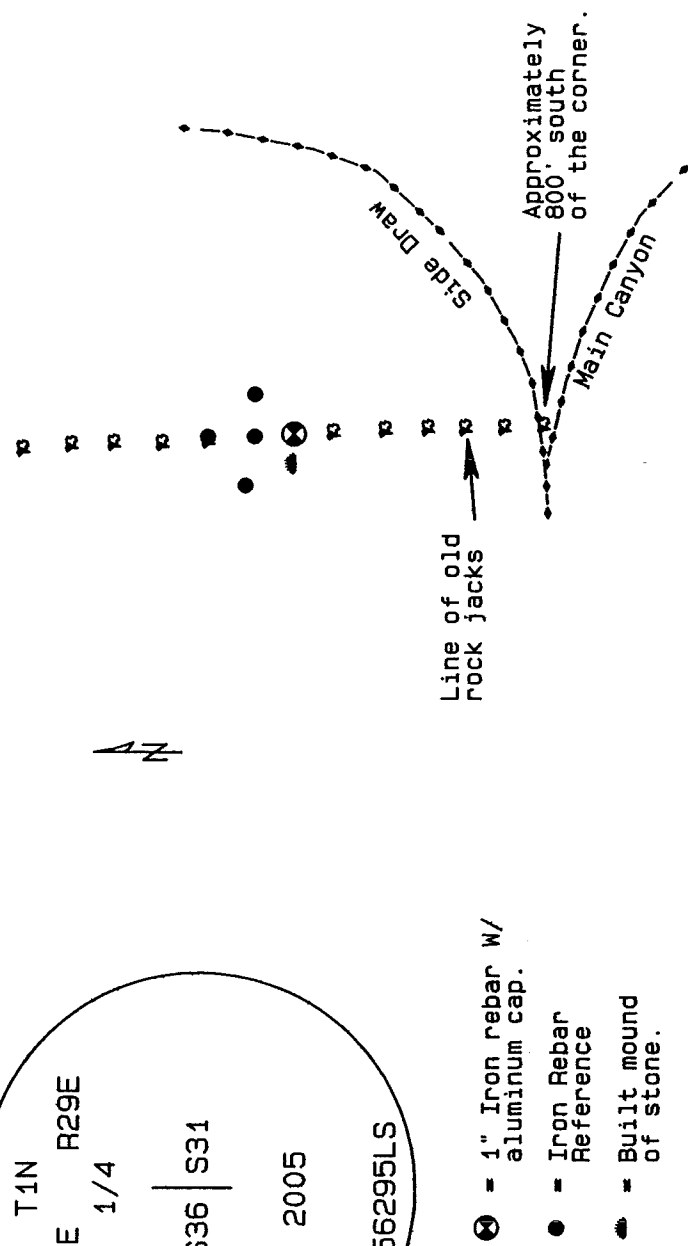

Monument and accessories set: (Procedures and description)

I set a 1" x 24" iron rebar with a 2" aluminum cap stamped as shown in the diagram 18" into the ground to the bedrock. I built a 24" mound of dirt and stone to the top of the cap. I built a mound of stone 4' wide by 2' high 5' west of the cap. I buried the stone on the north side of the rebar.

For references I set four 5/8" x 18" iron rebars with 1.25" orange plastic caps stamped WTS and 56295LS to bedrock:
an iron rebar bears N52°46'51"E 44.89 feet;
an iron rebar bears N05°23'01"E 27.36 feet;
an iron rebar bears N02°01'03"E 63.69 feet;
an iron rebar bears N46°16'38"W 49.71 feet;

The monument and references were tied with a Trimble R7/R8 GPS system using static surveying procedures. Bearings and distances are grid.

Location and Comments
SPC Oregon North, NAD 83-91
Northing = 679,402.15 ift
Easting = 8,522,886.51 ift

Compass Declination

Surveyor's Seal

Witnessed By:

RECEIVED BY:
Umatilla County Surveyor

Date: 5-05
Rec'd By: KK
No. 05-111-C

Firm / Agency
Witness Tree Surveying
P.O. Box G
Pilot Rock, OR 97868
Party Chief
Stephen K. Haddock, PLS

REGISTERED
PROFESSIONAL
LAND SURVEYOR

Stephen K. Haddock

OREGON
JULY 9, 2001
STEPHEN K. HADDOCK
56295LS

RENEWAL DATE 6-30-05