

OREGON CORNER RESTORATION FORM

Section 20 Township 1N Range 27E
 County Morrow Date: July 13th, 2017

Corner Designation: 1N27N9

Corner common to sections 16, 17, 20, and 21, T1N, R27E, W.M., Morrow County, Oregon.

Condition Report Only
 Not found
 Remonumented
 Unrecorded
 Surveyed in
 Referenced out

Previous Renewals / Surveys, etc.

The corner was originally set by David P. Thompson under contract 122 dated June 13, 1867. Hls record reads: Set post for corner to Secs. 16, 17, 20 & 21 in mound of earth with charred stak pits & C as per instructions. D.V.S. Reid in Morrow County Survey folder No. 1095 states he found the original charred stake and set a cast iron stove door and a rock 14x8x6 with additional charcoal and a second charred stake on top of the original. He also set a little round rock with cast iron stove parts and a stone 6x5x4 marked "wc" for a witness corner 45 links south.

Monument and Accessories found: (condition and source)

I found the stake and charcoal beside a cast iron stove door. A part of the corner stone had been broken off by road grading. I also found cast iron stove parts and the witness stone plainly marked "wc". I did not dig up Reid's four additional references.

DIAGRAM

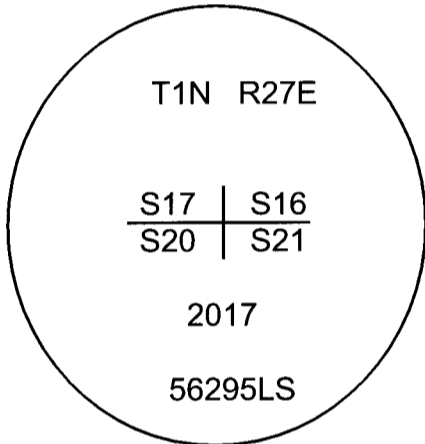

- ⊗ = Brass Cap
- = Rebar Reference
- △ = Witness Corner Stone

SKETCH

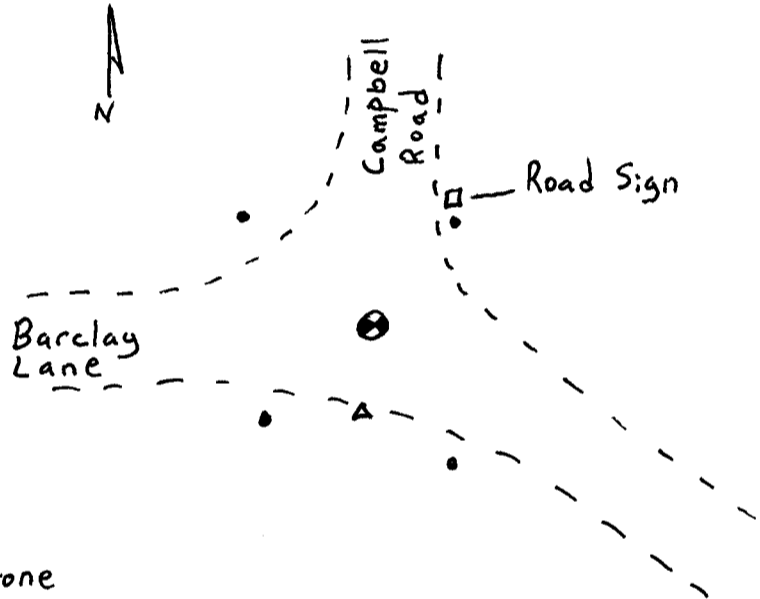

MONUMENT (S) AND ACCESSORIES SET (Procedures and Description)

I set a 2 3/8" brass cap on a 1 1/2" x 30" galvanized iron pipe in the ground to bedrock at the position of the original charred stake. The cap is 4" below the surface of the gravel road. The Remains of the charred stake are buried in an aluminum can on the west side of the iron pipe and the cast iron stove door is buried on the east side of the pipe.

For references, I set four, 5/8" by 24" rebars with 1.25" orange plastic caps stamped WTS and 56295LS as described below:

- an iron rebar bears N36°37'48"W, 54.13 feet 12" below the surface of a plowed field;
 - an iron rebar bears N31°46'41"E, 55.61 feet;
 - an iron rebar bears S23°28'38"E, 56.02 feet 12" below the surface of a plowed field;
 - an iron rebar bears S38°07'50"W, 39.63 feet 12" below the surface of a plowed field;
 - the stone witness corner by Reid bears S1°23'57"E 30.22' 1 foot below the surface of the ditch;
- Measurements were made with a Trimble RTK GPS.

Location and comments
 Witnessed by:

Compass Declination

Surveyors Seal

RECEIVED BY:
Morrow County Surveyor
 Date: 7-19-2017
 Rec'd By: S. K. H.
 No. 1N27N9

Firm / Agency
Morrow County Surveyor
 Address
P.O. Box G
Pilot Rock, Or. 97868
 Party Chief

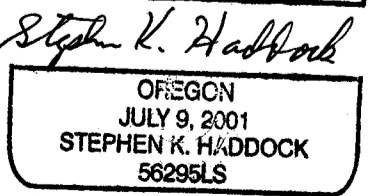
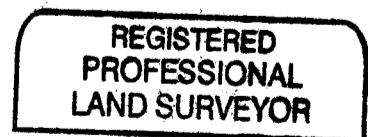

RENEWS: 6-30-19