

# OREGON CORNER RESTORATION FORM

T1N R27E E1

Section 6, Township 1N, Range 27E,  
County Morrow, Date January 31, 2005.

|          |                  |
|----------|------------------|
| —        | Condition Report |
| —        | Not Found        |
| —        | Remonumented     |
| —        | Unrecorded       |
| <u>X</u> | Surveyed in      |
| <u>X</u> | Referenced out   |

Corner common to T1N, R26E, Sections 1 & 12 and T1N, R27E, Sections 6 & 7, W.M., Morrow County, Oregon.

Previous Renewals / Surveys, etc.

The corner was originally set by Ebenezer Haft under Contract No. 93 dated September 11, 1860. His record Reads: Set post for corner to Secs 1, 12, 6 & 7 in mound with trench and pits and deposited 1 pint of charcoal as per instructions.

Monument and accessories found: (Condition and source)  
None. This position falls in the center of the County Road.

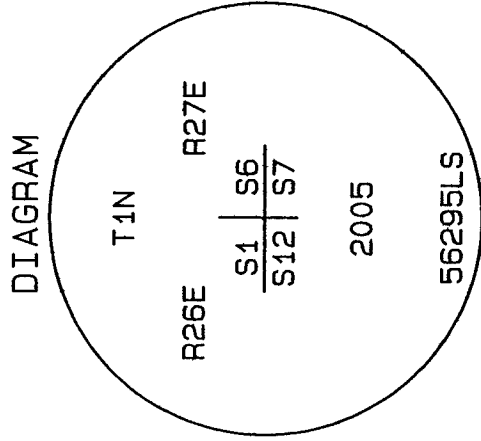

SKETCH

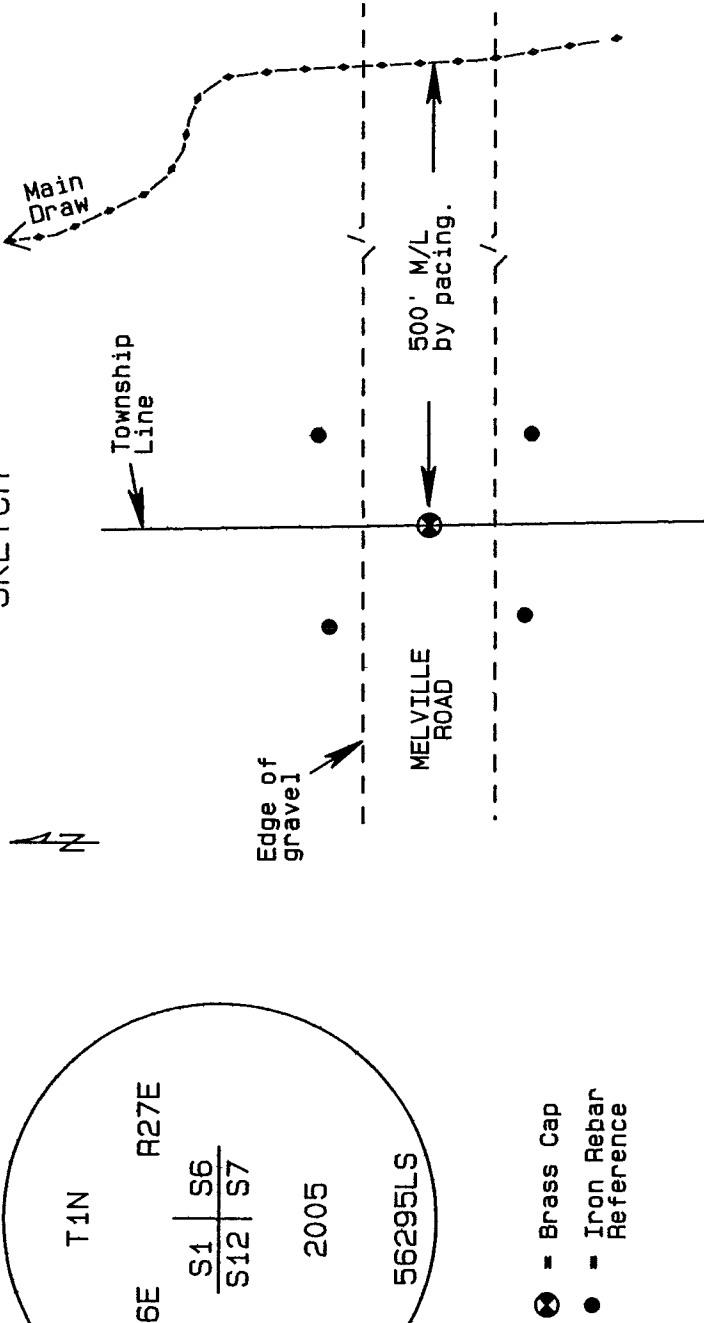

- ⊗ = Brass Cap
- = Iron Rebar Reference

Monument and accessories set: (Procedures and description)

At the intersection of the Township line with the centerline of County Road 696 I set a 2 3/8" x 30" galvanized iron pipe with a 2 3/8" brass cap stamped as shown above approximately 10" below the surface of the road.

For references I set four 5/8" x 24" iron rebars with 1.25" orange plastic caps attached stamped WTS and 56295LS 24" below the surface of the field:  
an iron rebar bears N39°13'59"E 22.37 feet;  
an iron rebar bears N45°47'51"W 22.30 feet;  
an iron rebar bears S42°55'44"W 20.59 feet;  
an iron rebar bears S42°04'11"E 21.63 feet;

The monument and references were tied with a Trimble R7/R8 GPS system using static surveying procedures. Bearings and distances are grid.

Location and Comments  
SPC Oregon North, NAD 83-91  
Northing = 702,284.13 ift  
Easting = 8,458,536.74 ift

Compass Declination

Surveyor's Seal

Witnessed By:

RECEIVED BY:  
Umatilla County Surveyor

Date: 5-05

Rec'd By: KK

No. 05-111-C

Firm / Agency  
Witness Tree Surveying  
P.O. Box G  
Pilot Rock, OR 97868  
Party Chief  
Stephen K. Haddock, PLS

REGISTERED  
PROFESSIONAL  
LAND SURVEYOR

*Stephen K. Haddock*

OREGON  
JULY 9, 2001  
STEPHEN K. HADDOCK  
56295LS

RENEWAL DATE 6-30-05