

OREGON CORNER RESTORATION FORM

Section 27 Township 1N Range 23E
County Morrow Date November 20, 1997

CORNER DESIGNATION

T-17
E 1/4

_____	Condition Report Only
_____	Not Found
_____	Renewed
_____	Unrecorded
<input checked="" type="checkbox"/>	Surveyed In
<input checked="" type="checkbox"/>	Referenced Out

Previous Renewals/Surveys, etc. Originally set under contract #119 in 1867 by Thompson;
He set a charred stake in a raised sand mound.

Monument(s) & Accessories Found: _____ **(Condition and Source)**
No evidence of original monument was found.

Monument Detail _____ **Sketch**

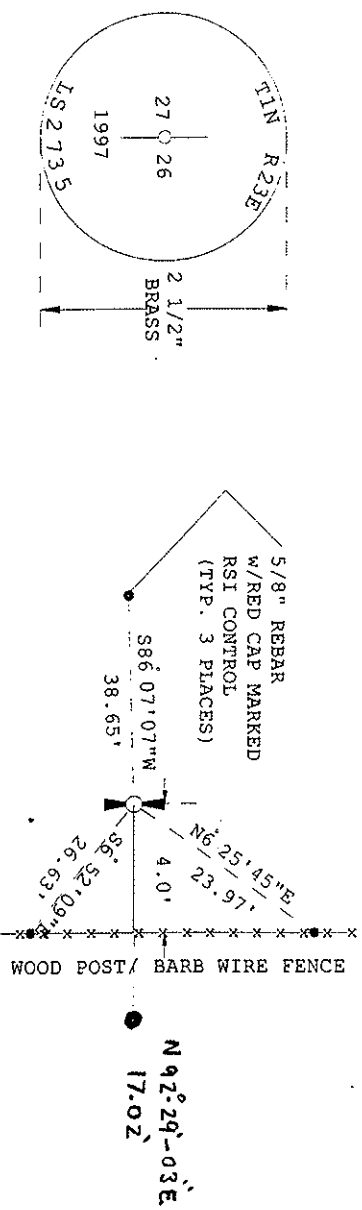

Monument Set (Procedures and Description)
Holding fence corners to north and south, position was determined by single proportion, then 1" X 24" sch. 40 steel pipe with 6" flared end, and 2 1/2 brass cap set.
Monument was set utilizing Trimble 4000SSI with Real Time Kinematic methods.

New Accessories
5/8" rebar with red cap marked RSI control bears N 6°25'45"E 23.97' (grid)
5/8" rebar with red cap marked RSI control bears S86°07'07"W 38.65' (grid)
5/8" rebar with red cap marked RSI control bears S 6°52'09"E 26.63' (grid)
5/8" rebar with red cap marked RSI control bears N 92° 29' 03" E 17.02 (grid)

Surveyor's Seal

Location & Comments
NAD 83/91 Oregon North Compass Declination 20 1/2
Grid coordinates (Int'l. Feet) Firm/Agency Rogers Surveying
N: 683005.78 Address 2304 N. 1st Street
E: 8351829.09 Hermiston, OR 97838
Referenced from Tri Sta. Party Chief E. Todd Pierce
Saddle Butte Notes _____
N: 672388.08 Witness _____
E: 8351122.09

