

**OREGON CORNER RESTORATION FORM**

Section 27 Township 1N Range 23E  
County Morrow Date December 2, 1997

**CORNER DESIGNATION**

**T-13**  
**W 1/4**

_____	Condition Report Only
_____	Not Found
_____	Renewed
_____	Unrecorded
<input checked="" type="checkbox"/>	Surveyed In
<input checked="" type="checkbox"/>	Referenced Out

**Previous Renewals/Surveys, etc.** Originally set under contract #119 in 1867 by Thompson;  
He set a charred stake in a raised sand mound.

**Monument(s) & Accessories Found:** (Condition and Source)

No evidence of original monumentation found. Fence corners north and south evidencing Possession found.

**Monument Detail**

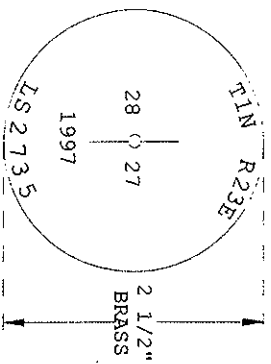

**Sketch**

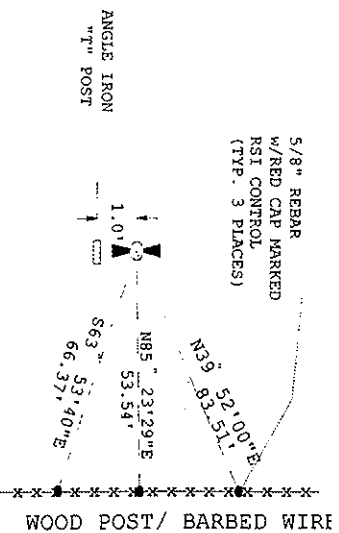

**Monument Set (Procedures and Description)**

Held fence corners to north and south at section corners evidencing possession, position was Determined by single proportion and a 1" X 24" sch. 40 steel pipe with 6" flared end and 2 1/2" brass cap was set. Monument set utilizing Trimble 4000SSI GPS receivers with Real Time Kinematic methods.

**New Accessories**

- 5/8" rebar with red cap marked RSI control bears N 39°52'00"E 83.51 (grid)
- 5/8" rebar with red cap marked RSI control bears S 63°53'40"E 66.37 (grid)
- "T" angle iron fence post bears south 1.0 foot.
- 5/8" rebar with red cap marked RS control bears N85°23'29"E 53.54 (grid)

**Surveyor's Seal**

**Location & Comments**  
 NAD 83/91 Oregon North      Compass Declination      20 1/2°  
 Grid coordinates (Int'l. Feet)      Firm/Agency      Rogers Surveying  
 N: 683057.79      Address      2304 N. 1st Street  
 E: 8346576.72      Hermiston, OR 97838  
 Referenced from Tri Sta.      Party Chief      E. Todd Pierce  
 Saddle Butte      Notes      \_\_\_\_\_  
 N: 672388.08      Witness      Mark A. Baalman  
 E: 8351122.09

