

M-34481

A

BEFORE THE MORROW COUNTY COURT
OF MORROW COUNTY

AN ORDINANCE AMENDING THE)
COMPREHENSIVE PLAN AND ZONING)
ORDINANCE MAP IN THE UNINCORPORATED)
AREAS OF THE PORT OF MORROW, MORROW)
COUNTY, OREGON, AND DECLARING AN)
EMERGENCY. AREA INVOLVED IS:)
4N, R25, S3, TL 101, 102, 103;)
4N, R25, S10, TL 100, 300, 400,)
500, 1900, 2000, 2100; AND)
4N R25, S11, TL 102 AND 108)

ORDINANCE NO. MC-C-1-90

The County of Morrow does ordain as follows:

WHEREAS, Morrow County adopted a Comprehensive Land Use Plan on January 15, 1986; and

WHEREAS, Notice of Hearing was given in accordance with law; and

WHEREAS, The Morrow County Court has reviewed the recommendations of the Morrow County Planning Commission; and

WHEREAS, said Planning Commission has held two public hearings at the request of the Port of Morrow; and

WHEREAS, No appeals or objections have been filed or recorded as a result of said hearings;

NOW THEREFORE, be it ordered by the Morrow County Court, that the attached map Marked Exhibit "A" amending the Morrow County Zoning Map to rezone those properties owned by the Port of Morrow now zoned MG, Morrow County General Industrial, to Port Industrial Zone, said action to be taken to provide continuity of land use with the remaining PI zoned land owned by the Port of Morrow.

This Ordinance shall take effect upon the unanimous vote of the County Court and the passage of ten (10) consecutive working days and the attestation by the Morrow County Clerk.

Dated this 14th day of February 1990.

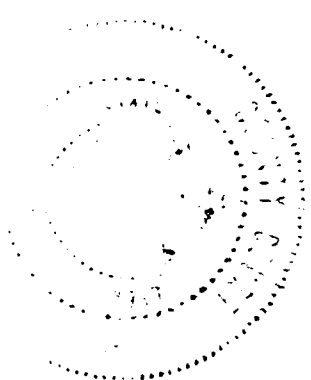

Louis A. Carlson
Louis A. Carlson, JUDGE

Irvin Rauch
Irvin Rauch, COMMISSIONER

Jerry Peck
Jerry Peck, COMMISSIONER

ATTEST:

Barbara Bloodsworth
Barbara Bloodsworth, County Clerk

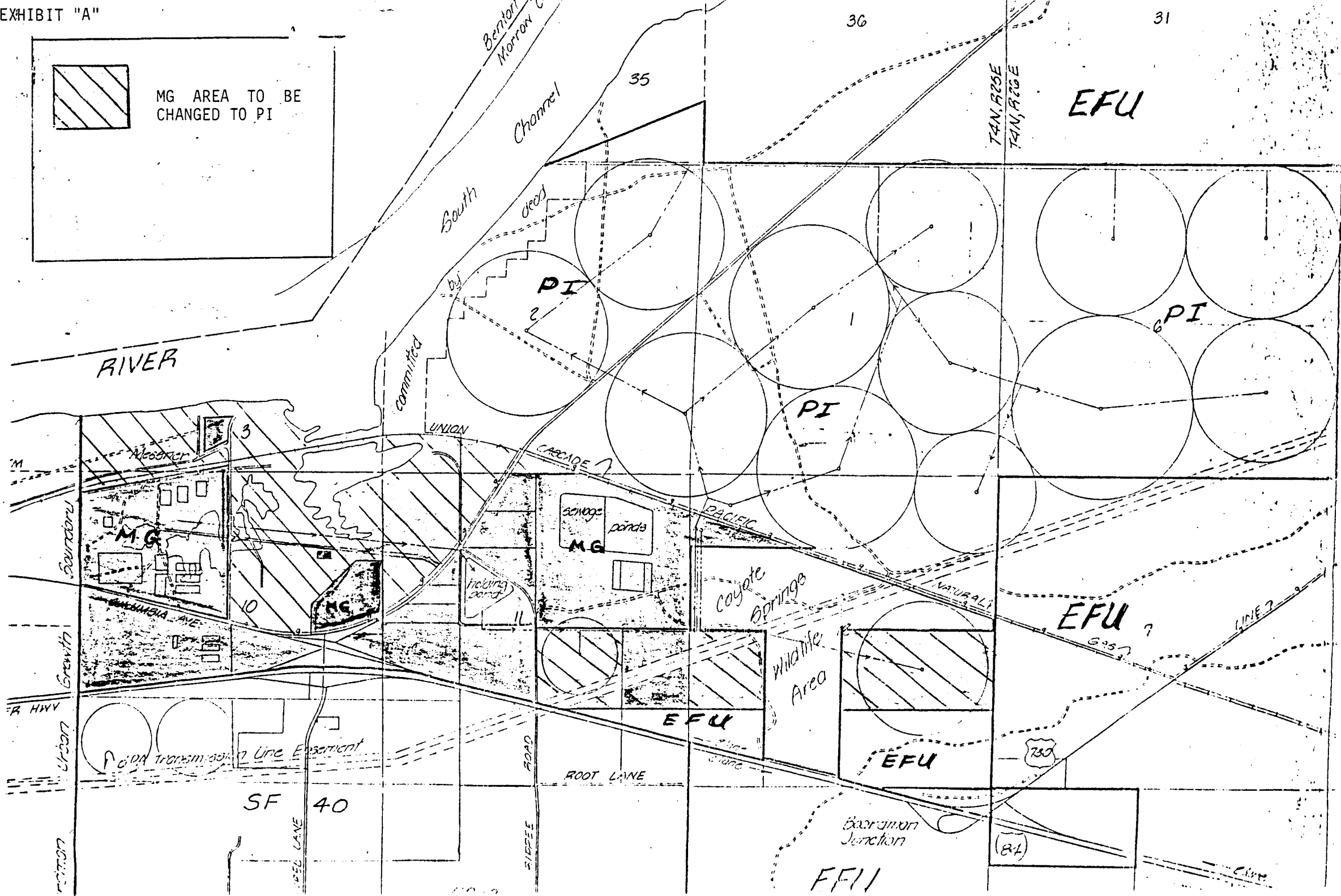
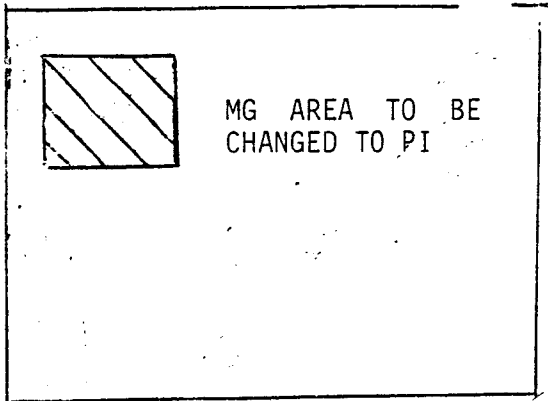

STATE OF OREGON
County of Morrow

149972
ss. INDEXED

I hereby certify that the within
instrument was received for record.

on 02-14-90 at 10:44 am

and assigned No. 34481

in the Microfilm Records of said
county

Witness My Hand and Seal of County
Affixed

Barbara Bloodsworth
County Clerk

By *Shirley M. Paul*
Deputy